

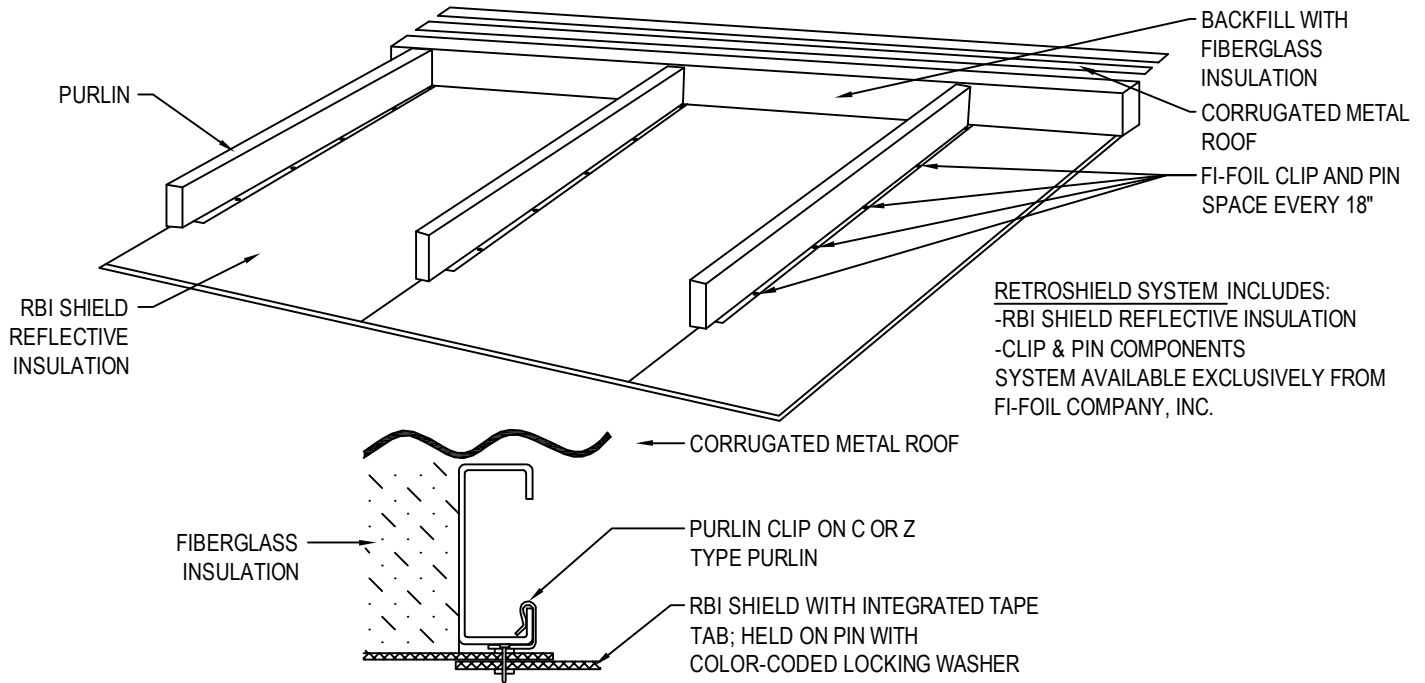

FI-FOIL COMPANY, INC.  
 P.O. BOX 800  
 AUBURNDALE, FL 33823  
 TOLL FREE: 1-800-448-3401  
 FAX: (863) 967-0137  
 www.fifoil.com



RETROSHIELD SYSTEM INCLUDES:  
 -RBI SHIELD REFLECTIVE INSULATION  
 -CLIP & PIN COMPONENTS  
 SYSTEM AVAILABLE EXCLUSIVELY FROM  
 FI-FOIL COMPANY, INC.

RETROSHIELD WITH WHITE EXPOSED	DIRECTION OF HEAT FLOW	VALUE OF FIBERGLASS INSULATION**	ADDED R WITH RETROSHIELD SYSTEM	TOTAL R-VALUE
ROOF - SUMMER	DOWN	R-19	R-1.92	R-20.92
ROOF - WINTER	UP	R-19	R-1.61	R-20.61
WALLS - SUMMER AND WINTER	HORIZONTAL	R-19	R-1.68	R-20.68

RETROSHIELD WITH ALUMINUM EXPOSED	DIRECTION OF HEAT FLOW	VALUE OF FIBERGLASS INSULATION**	ADDED R WITH RETROSHIELD SYSTEM	TOTAL R-VALUE
ROOF - SUMMER	DOWN	R-19	R-5.55	R-24.55
ROOF - WINTER	UP	R-19	R-2.32	R-21.32
WALLS - SUMMER AND WINTER	HORIZONTAL	R-19	R-2.70	R-21.70

\*INCLUDES R1 FOR RBI BUBBLE PLUS ASHRAE AIR FILM COEFFICIENT FOR NON-REFLECTIVE 0.90 (WHITE) AND REFLECTIVE 0.05 (ALUMINUM) EXPOSED. 2013 ASHRAE HANDBOOK OF FUNDAMENTALS, CHAPTER 26, SECTION 26.20, TABLE 10, SURFACE FILMS COEFFICIENT/RESISTANCES.

\*\*R-19 FIBERGLASS INSULATION CAN BE SUBSTITUTED FOR OTHER R-VALUE INSULATION, AND THE R-VALUE FOR RETROSHIELD SYSTEM WILL REMAIN THE SAME.

**NOTES:**

1. INSTALLATION TO BE COMPLETED IN ACCORDANCE WITH MANUFACTURER'S SPECIFICATIONS.
2. DO NOT SCALE DRAWING.
3. THIS DRAWING IS INTENDED FOR USE BY ARCHITECTS, ENGINEERS, CONTRACTORS, CONSULTANTS AND DESIGN PROFESSIONALS FOR PLANNING PURPOSES ONLY. THIS DRAWING MAY NOT BE USED FOR CONSTRUCTION.
4. ALL INFORMATION CONTAINED HEREIN WAS CURRENT AT THE TIME OF DEVELOPMENT BUT MUST BE REVIEWED AND APPROVED BY THE PRODUCT MANUFACTURER TO BE CONSIDERED ACCURATE.
5. CONTRACTOR'S NOTE: FOR PRODUCT AND COMPANY INFORMATION VISIT [www.CADdetails.com/info](http://www.CADdetails.com/info) AND ENTER REFERENCE NUMBER 647-018.

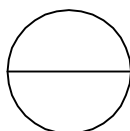

## RETROSHIELD SYSTEM

RBI SHIELD ATTACHED TO BOTTOM OF PURLINS, BACK-FILLED WITH UNFACED BATT INSULATION